



Download

Edit

Versions

Data Quality Level 1

Data Quality Level 2

Data Quality Level 3

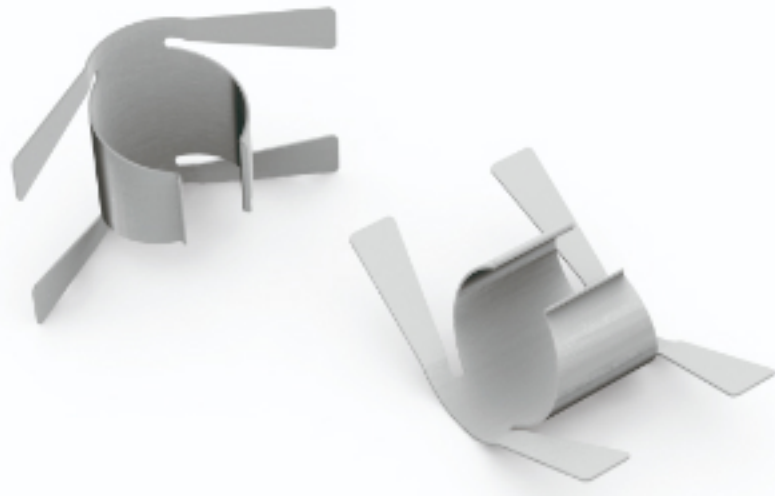

Tilmar B.V.

### TubiClic RVS buisklem

Self Reported

Cradle To Gate 6



#### Description

TubiClic stainless steel universal pipe clamp, for the flexible and easy fixing of pipes and tubes in machined wall grooves, 50pcs per carton box.

Segment: Plumbing/Heating/Ventilation/Air Conditioning

Family: Plumbing/Heating/Ventilation/Air Conditioning

Class: Plumbing/Heating/Ventilation/Air Conditioning Variety Packs

Brick: Plumbing/Heating Ventilation/Air Conditioning Variety Packs

Weight: 190g

Article No.: 120.2200.20

EAN: 8718026790684

GSES Product Number: GSP-0000-00052201

Delivery Unit: Per Product

Version: 2025-06-30



Product Impact Rating  
GSES



Plumbing/Heating/Ventilation/Air  
Conditioning Variety Packs class  
average: 23%

### Circular Footprint | 44%



Average for all products in the Plumbing/Heating/Ventilation/Air Conditioning Variety Packs class: 44%

|   | Total   | Class avg. |
|---|---------|------------|
| Recycled Content Used (Product) ⓘ         | 10 %    | 10 %       |
| Biobased Content Used (Product) ⓘ         | 0 %     | - %        |
| Compostable Content After Use (Product) ⓘ | 0 %     | - %        |
| Recyclable Content After Use (Product) ⓘ  | 76 %    | 76 %       |
| Warranty period ⓘ                         | 3 years |            |
| Detachability Index ⓘ                     | No      |            |
| Packaging Free Product ⓘ                  | No      |            |
| High Recycled Content Packaging ⓘ         | No      |            |
| Plastic Free Packaging ⓘ                  | Yes     |            |
| Reusable/Refillable Packaging ⓘ           | -       |            |

### Environmental Footprint | 30%



Average for all products in the Plumbing/Heating/Ventilation/Air Conditioning Variety Packs class: 30%

|  | Total  | Per kg | Class avg. |
|--|--------|--------|------------|
| Climate Change Potential (Product) ⓘ             | 0.955  | 5.026  | 1          |
| Climate Change Potential (Packaging) ⓘ           | 0      | 0.001  | 0          |
| Acidification Potential (Product) ⓘ              | 0.006  | 0.032  | 0          |
| Water use (Product) ⓘ                            | 5.521  | 29.058 | 6          |
| Primary Energy, Non-Renewable, Total (Product) ⓘ | 11.004 | 57.917 | 11         |

### Health Footprint | 6%



Average for all products in the Plumbing/Heating/Ventilation/Air Conditioning Variety Packs class: 6%

|   | Total                 | Per kg                |
|---|-----------------------|-----------------------|
| Ecotoxicity, freshwater (Product) ⓘ             | 33.014                | 173.759               |
| Human toxicity, cancer (Product) ⓘ              | $1.47 \times 10^{-8}$ | $7.74 \times 10^{-8}$ |
| Human toxicity, non-cancer (Product) ⓘ          | $4.25 \times 10^{-8}$ | $2.23 \times 10^{-8}$ |
| REACH Compliance ⓘ                              | No                    |                       |
| Additional Product Health Safety Declarations ⓘ | No                    |                       |

### Impact Assessment (PEF method) ⓘ

|   | Total                 | Per kg     |
|---|-----------------------|------------|
| Eutrophication Freshwater (in kg P eq)                      | $3.91 \times 10^{-5}$ | 0.0002     |
| Eutrophication Marine (in kg N eq)                          | $1.06 \times 10^{-3}$ | 0.0055     |
| Eutrophication Terrestrial (in mol N eq)                    | $1.21 \times 10^{-2}$ | 0.0625     |
| Ionising Radiation Human Health (in kBq U-235 eq)           | $2.83 \times 10^{-2}$ | 0.1489     |
| Land Use (in dimensionless (pt))                            | 8.66                  | 0.0453     |
| Ozone Depletion (in kg CFC-11 eq)                           | $4.91 \times 10^{-8}$ | 0.00000258 |
| Particulate Matter (in disease incidence)                   | $8.19 \times 10^{-8}$ | 0.00000431 |
| Photochemical Ozone Formation Human Health (in kg NMVOC eq) | $3.17 \times 10^{-3}$ | 0.0167     |
| Resource Use Fossils (in MJ)                                | $5.32 \times 10^{-1}$ | 0.002805   |
| Resource Use Minerals And Metals (in kg Sb eq)              | $3.32 \times 10^{-5}$ | 0.00000174 |
| Water Use Deprivation Potential (in m3 depriv.)             | $6.52 \times 10^{-2}$ | 0.003431   |

#### Product Bill of Materials

Export Bill of Materials

| Subject | Material  | Weight (154 gram) | Contribution ⓘ | Recycled Content Used | Biobased Content Used | Compostable After Use |
|---------|---|-------------------|----------------|-----------------------|-----------------------|-----------------------|
|         | Metal   Stainless steel (chromium / RVS)- sheet | 154               | 81%            | 10.4%                 | 0%                    | 0%                    |

#### Packaging Bill of Materials

| Subject | Material  | Weight (36 gram) | Recycled Content Used | Biobased Content Used | Compostable After Use | Actual Recycled Content |
|---------|---|------------------|-----------------------|-----------------------|-----------------------|-------------------------|
|         | Packaging   Carton board (based on cardboard box) | 36               | 69%                   | 10%                   | 0%                    | 60%                     |

#### Production country data

Kaart

Satelliet

Produced in Germany

#### Certificates & Supplier Certificates

No certificates available to show.